

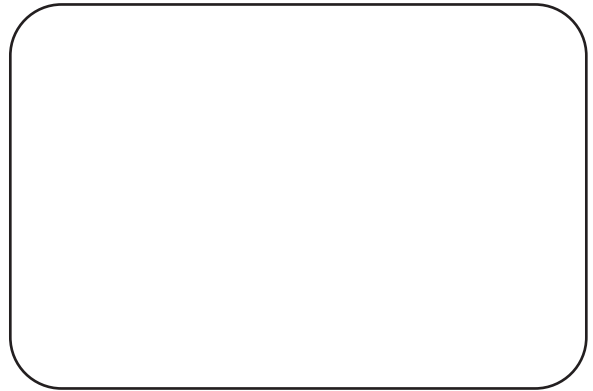

NORGAS

REGULATION & MEASUREMENT
NATIONAL • KNOWLEDGEABLE • IN-STOCK

Distributed By



Lubricated Plug Valves



Master Distributor for



MILLIKEN

Milliken Plug Valves

Cast Iron Rectangular Port / Reduced Bore

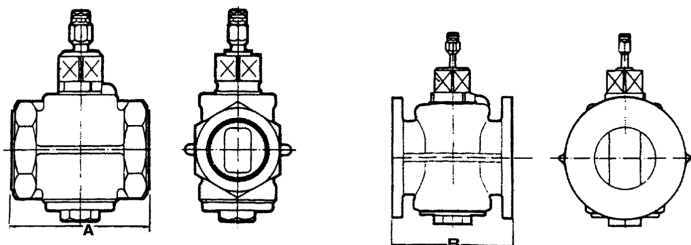

170M/171M ▼ 1 1/2" - 8" Wrench Operated

Nominal Size		in mm	1 1/2 40	2 50	2 1/2 65	3 80	4 100	5 125	6 150	8 200
170M End-to-End (Screwed)	A	in mm	4.38 111	6 152	6.50 165	7.38 187	8.88 225	- -	- -	- -
171M Face-to-Face (Flanged)	B	in mm	4.63 118	7 178	7.50 190	8 203	9 225	10 254	10.50 267	11.50 292
Diameter of Sealing Compound Stick		in mm	.38 9.5	.38 9.5	.50 13	.50 13	.63 16	.63 16	.63 16	.63 16
Wrench (Screwed valves)			J	J	L	L	O	-	-	-
Wrench (Flanged valves)			J	J	L	L	O	P	P	Q
Approximate Weight (Screwed)		lb kg	5.3 2.4	9.5 4.3	15 6.6	22 10	46 21	- -	- -	- -
Approximate Weight (Flanged)		lb kg	11 5	18 8.20	24 11	37 17	53 24	97 44	126 57	170 77

Specification

- 200 PSI rated at ambient temperature.
- Screwed end valves are supplied to ANSI B1.20.1.
- Flanged valves are supplied with flanges to ANSI B16.1, Class 125.
- Flanged valves face dimensions are in accordance with ANSI B16.10, short pattern
- 170M/171M - 200M/201M are CSA/CGA 3.11 Approved (1/2" - 8")

The principle of the Milliken plug valve is as simple as its design. The plug, which is the only moving part of the valve, when open, presents a straight through passage in line with the pipeline, and when turned through 90 degrees to the closed position stops the flow.

A special sealing lubricant is used to effect a completely leak tight seal. When pressure is applied to the valve in the closed position, the parallel plug is forced to the downstream side of the valve. The metal to metal contact of plug and body together with the barrier of sealing lubricant ensures a completely leak tight valve, with the sealant also acting as a lubricant and providing a barrier to reduce corrosion to the plug and body.

171MG ▼ 6" - 12" Gear Operated

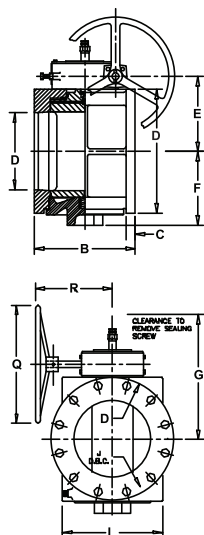

Nominal Size		in mm	6 150	8 200	10 250	12 300
171MG Face-to-Face (Flanged)	B	in mm	10.5 266	11.5 292	13 330	14 356
End CRS to Gear	E	in mm	8.39 213	9.50 241	11.94 303	13.69 348
Top CRS to Gear	R	in mm	10 254	10 254	10 254	10 254
Body Diameter	L	in mm	10.0 254	11.3 287	14 356	17 432
Gear / Wheel Size	Q	in mm	12 305	12 305	12 305	12 305
Approximate Weight		lb kg	157 70	210 95	359 163	493 224

Milliken Plug Valves

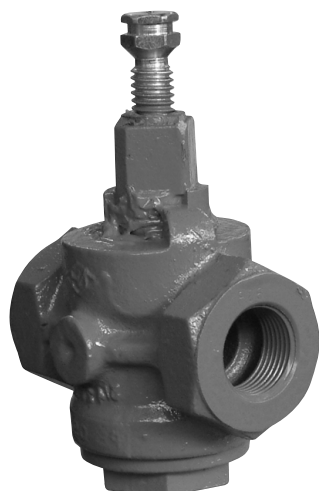

Cast Iron Rectangular Port / Full Bore

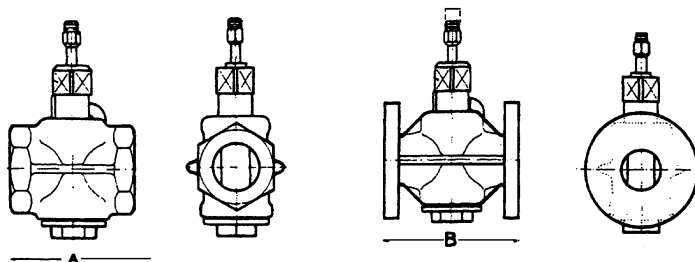

▼ 200M/201M

1/2" - 6"

Wrench Operated

Nominal Size		in mm	1/2 15	3/4 20	1 25	1 1/4 32	1 1/2 40	2 50	2 1/2 65	3 80	4 100	6 150
200M End-to-End (Screwed)	A	in mm	3.19 81	3.5 88	4.19 106	4.38 111	4.63 117	6 152	6.5 165	7.38 187		
201M Face-to-Face (Flanged)	B	in mm	-	-	-	-	-	7 178	7.5 190	8 203	9 229	10.5 267
Diameter of Sealing Compound Stick		in mm	.38 9.5	.38 9.5	.38 9.5	.38 9.5	.38 9.5	.5 13	.5 13	.63 16	.63 16	.63 16
Wrench			G	G	G	J	J	L	L	O	P	Q
Approximate Weight (Screwed)		lb kg	1.8 .8	2.6 1.2	4.6 2.1	5.7 2.6	6.8 3.1	13 6	19 8.8	31 14	-	-
Approximate Weight (Flanged)		lb kg	-	-	-	-	-	22 10	29 13	42 19	84 38	170 77

Gearing

The Milliken plug valves are available with gear operator options. In this catalogue, we have indicated in the dimensions tables, which valves are fitted with gear operators.

Routine Maintenance

The only maintenance required on plug valves is periodic re-lubrication with valve sealant. Frequency of lubrication should be established for each specific service since requirements will vary widely with temperature, pressure, service fluid and frequency of operation.

Lubricant / Sealant Options

A wide variety of lubricants are available for many different service applications such as oil, asphalt and gases. Most lubricants are available in stick and cartridge form. An economical alternative to removing a valve from the line or disassembling and cleaning, valve cleaner is available to dissolve hardened debris within the sealant system.

▼ 201MG

6" - 8"

Gear Operated

Nominal Size		in mm	6 150	8 200
201MG Face-to-Face (Flanged)	B	in mm	10.5 267	11.5 292
End CRS to Gear	M	in mm	8.13 206	10.44 265
Top CRS to Gear	N	in mm	10 254	10 254
Gear / Wheel Size	P	in mm	12 305	12 305
Body Diameter	Q	in mm	11.5 292	14 356
Approximate Weight		lb kg	209 95	367 167

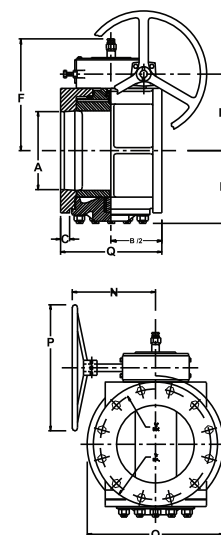

200L/T • 301L/T • 301LG/TG

Class 125 – ANSI B16.1 Flanges Class 125 – NPT Screwed End Valves Three-way Pattern • Full Bore • Rectangular Port

Specification

Screwed end valves are supplied screwed to NPT standards.
Flanged valves are supplied with flanges to ANSI B16.1, Class 125.

Valve Identification

End Connections	Operation	Fig#
Non-Transflow		
Screwed	Wrench	200L/T
Flanged	Wrench	301L/T
Flanged	Geared	301LG/TG

▼ 200L - 200T Wrench Operated

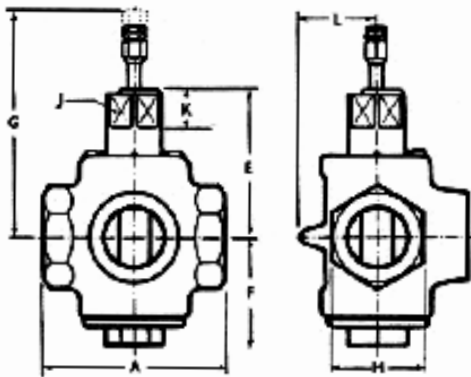

Nominal Size *		in mm	¾ 20	1 25	1½ 40	2 50
200L/T End-to-End (Screwed)	A	in mm	3.88 99	4.25 108	5.50 140	6.75 162
Center of Port to Top of Plug	E	in mm	2.63 67	3.13 79	4.50 114	5.38 137
Center of Port to Bottom	F	in mm	1.88 48	2.13 54	3 76	3.75 95
Clearance to Remove Sealing Screw	G	in mm	4.25 108	4.63 118	5.25 133	8.13 206
Square of Plug Head A/F	J	in mm	.84 21	1.06 27	1.38 35	1.38 35
Height of Plug Head	K	in mm	.88 22	1 25	1.38 35	1.38 35
Center of Valve to Edge of Rib	L	in mm	1.13 29	1.63 41	2.25 57	2.63 67
Diameter of Sealing Compound Stick		in mm	.38 9.50	.38 9.50	.38 9.50	.50 13
Wrench			G	J	L	L
Approximate Weight (Screwed)		lb kg	3.50 1.60	5.50 2.50	11 5.20	18 8.40

▼ 301L - 301T Wrench Operated

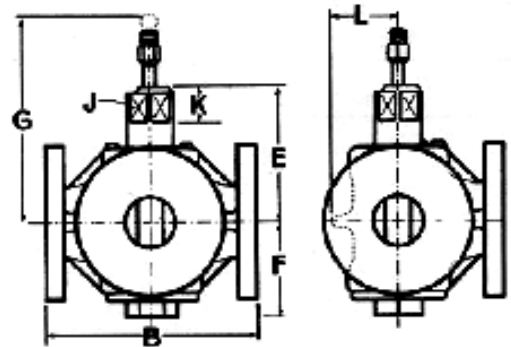

Nominal Size *		in mm	2½ 65	3 80	4 100
301L/T Face-to-Face (Flanged)	B	in mm	10 254	11.50 292	14 356
Center of Port to Top of Plug	E	in mm	6.13 156	6.88 175	8.50 216
Center of Port to Bottom	F	in mm	4.38 111	5.38 137	6 152
Clearance to Remove Sealing Screw	G	in mm	8.75 222	10.13 257	11.88 302
Square of Plug Head A/F	J	in mm	2 51	2.25 57	2.69 68
Height of Plug Head	K	in mm	2 51	2 51	2.50 64
Center of Valve to Edge of Rib	L	in mm	3.38 86	4.38 111	6 152
Diameter of Sealing Compound Stick		in mm	.50 13	.63 16	.63 16
Wrench			O	P	Q
Approximate Weight (Flanged)		lb kg	53 24	86 39	180 82



* Other sizes available.

Multi-Port Valve

Optional Patterns

Three-way Valve Port Positions

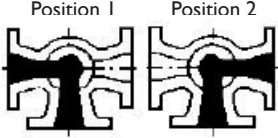
(View is from Top of Valve)

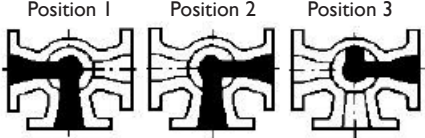
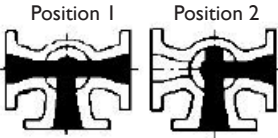
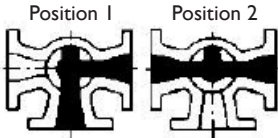
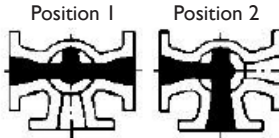
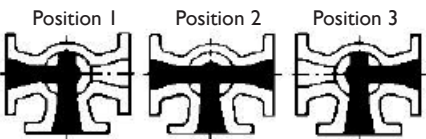
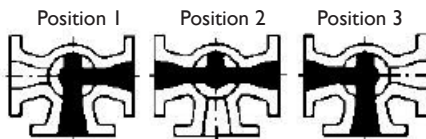
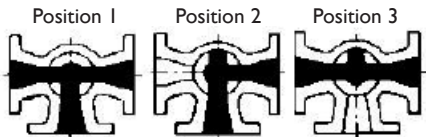
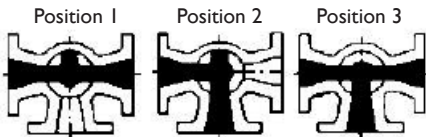
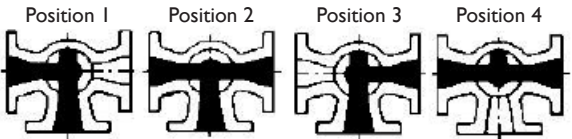
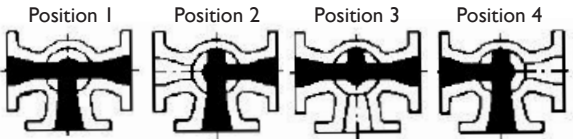
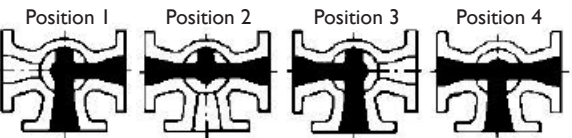
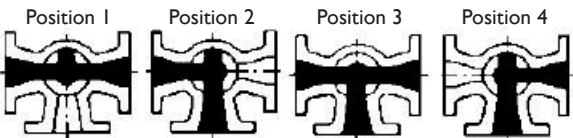
 <p>Position 1 Position 2</p> <p>3-way, 2-port, 90° turn</p> <p>▲ Style A*</p>	 <p>Position 1 Position 2 Position 3</p> <p>3-way, 2-port, 180° turn</p> <p>▲ Style P</p>	 <p>Position 1 Position 2 Position 3</p> <p>3-way, 2-port, 180° turn</p> <p>▲ Style R</p>	
 <p>Position 1 Position 2</p> <p>3-way, 3-port, 90° turn</p> <p>▲ Style D</p>	 <p>Position 1 Position 2</p> <p>3-way, 3-port, 90° turn</p> <p>▲ Style E</p>	 <p>Position 1 Position 2</p> <p>3-way, 3-port, 90° turn</p> <p>▲ Style F</p>	
 <p>Position 1 Position 2 Position 3</p> <p>3-way, 3-port, 180° turn</p> <p>▲ Style G</p>		 <p>Position 1 Position 2 Position 3</p> <p>3-way, 3-port, 180° turn</p> <p>▲ Style H</p>	
 <p>Position 1 Position 2 Position 3</p> <p>3-way, 3-port, 180° turn</p> <p>▲ Style I</p>		 <p>Position 1 Position 2 Position 3</p> <p>3-way, 3-port, 180° turn</p> <p>▲ Style J</p>	
 <p>Position 1 Position 2 Position 3 Position 4</p> <p>3-way, 3-port, 270° turn</p> <p>▲ Style K</p>		 <p>Position 1 Position 2 Position 3 Position 4</p> <p>3-way, 3-port, 270° turn</p> <p>▲ Style L</p>	
 <p>Position 1 Position 2 Position 3 Position 4</p> <p>3-way, 3-port, 270° turn</p> <p>▲ Style M</p>		 <p>Position 1 Position 2 Position 3 Position 4</p> <p>3-way, 3-port, 270° turn</p> <p>▲ Style N</p>	

When ordering Three-way valves, specify the size and figure number of the valve, plus the style letter of the port position desired.
 Example: 3" - Figure 301T, Style C, Three-way valves are furnished without stop-rings to allow a full 360° turn, as standard.

Valves are normally supplied without stops, but limiting stops can be fitted at extra cost.

*Also available in 3-way, 2-port for 180° turn, right or left hand operation.

Accessories

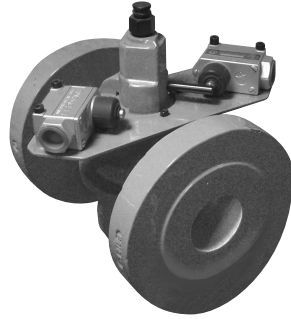

▼ Limit Switches ▼

Open and closed position limit switches can easily be fitted to both wrench and gear operated valves.



▼ Power Actuation ▼

A variety of pneumatic, hydraulic and electric actuators can be fitted to Milliken valves. Actuators supplied by leading manufacturers can be fitted including accessories such as limit switches and positioners.



▼ Lubricant Guns and Lubricants ▼

Lubricant types available for a wide range of services; Natural Gas, Propane, Landfill Gas etc. Plus various Lubricant Guns are available for efficient and controlled plug valve Lubrication. Handles the heaviest plug valve lubricant/sealants. Builds pressure up to 10,000 lbs.

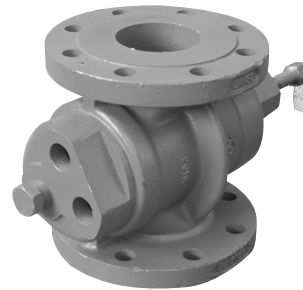

▼ Steam Jacketed Covers

A range of steam jacketed covers can be fitted to Milliken valves. Steam jackets are used on viscous services, such as asphalt, where heat is required to keep in a liquid state. Steam jackets can also be installed on 3 way valves.



▼ Wrenches

A malleable iron wrench is available with all CSA approved Lubricated Plug valves. A variety of wrenches including standard operated and chain wrench are also available. The standard wrench is removable but can be fixed to the valve by means of a setscrew.



▼ Locking Device

Locking devices can be fitted onto wrench valves. A padlock and key is then used to lock the valve into the required position.

Comparison Chart

Cast Iron – Lubricated Plug Valve

Milliken	Homestead	Resun	Nordstrom	Neo Valves
170M	611	R-1430	142	
171M	612	R-1431	143	1-AS 40114
171MG	612-G	R-1431-WGA	149	1-AS 40114-C
200M	601	D-125	114	1-AR 40034
201M	602	D-126	115	
201MG	602-G	D-126-WGA	189	
200MSJ	601-SJ	D-125-SJ		
201MSJ	602-SJ	D-126-SJ	2815 / 2865	
200L	603	D-951	3402	
301L	604	D-952	3403 / 3465	
301LSJ	604-SJ	D-952-SJ		
301LG	604-G	D-952-WGA	3469	
200T	605	D-953	3412	
301T	606	D-954	3413 / 3475	
200LSJ	603-SJ	D-951-SJ		
200TSJ	605-SJ	D-953-SJ		
301TSJ	606-SJ	D-954-SJ	3479	
301TG	606-G	D-954-WGA		

* The above chart is meant as a general cross-reference only. For specific comparisons with reference to face-to-face, pressure and flow capacity contact Norgas Controls Inc.

NORGAS

REGULATION & MEASUREMENT
NATIONAL • KNOWLEDGEABLE • IN-STOCK



MILLIKEN

Lubricated Plug Valves & Accessories

